



STEEL THE WORLD TRUSTS

Board of Directors



Emphasis on “Do it right the first time and every time”

K.E. MOIDU
Managing Director

Peekay Steel Castings Pvt. Ltd.

Peekay Steel Castings Pvt. Ltd., is a leading steel manufacturing unit with foundries situated in Calicut, Kerala and Coimbatore, Tamil Nadu. The company manufactures Steel Castings of carbon steel, stainless steel, alloy steels of various compositions and nickel based alloy steel for different types of steel castings in various sizes and weights up to 11000 Kg per piece for oil and gas sector, transportation, mining, power and other engineering sectors. Peekay Steel Castings (P) Ltd is the flag ship company of Peekay group which plays a vital role in the industrial development of Kerala. The company was incorporated with the Registrar of Companies, Kerala as a private limited company on 09.04.1991.

The company employs most modern technology and has installed state-of-the-art machinery and equipment for the manufacture of high quality steel castings. It has the most modern and sophisticated quality control laboratory for all types of physical and chemical testing and a radiography enclosure room with Cobalt 60 and Iridium 192 for radiography testing of castings. The entire manufacturing process and service departments are supervised and managed by qualified, experienced and competent personnel. The company

constantly upgrades its technology and employs the most advanced technology available in the foundry sector. A fully equipped Machine Shop with imported machinery is attached to the Calicut foundry for meeting the growing demand for machined, ready to use castings/components for the oil and gas and other engineering sectors.

Both Calicut and Coimbatore foundries together produce 13,200 Tonnes steel castings per annum. The steel castings are exported to various countries of the European Union, notably Germany, France, Italy, U.K., Netherlands, Spain, and Belgium, USA, Canada, Japan, Korea, Singapore and UAE. It is the policy of the company to produce consistently castings conforming to customer specifications in terms of quality and delivery. The company holds several certification and recognition from renowned international agencies. The company holds the largest number of international certification under one umbrella in India.



Your Success Our Commitment



PEEKAY STEEL CASTINGS (P) LTD shall consistently and diligently manufacture products exceeding the expectation of our customers, to remain a leader in casting market by excellence in total quality performance. The foundry is committed to its quality policy and objectives. To achieve this, the foundry has formulated a quality systems and assurance program to bring about improvements in all areas of operation including:

- Continuous effort to improve product quality
- Training and motivation of employees
- Improve professionalism and competence
- Reduce rejections, rework & wastage and conserve energy

Vision

To be an engineering conglomerate and lead Peekay to new horizons, expanding and diversifying to new industries and cutting edge technologies. A one stop supplier to all the major OEM's globally in terms of ready to assemble machined castings, forging and fabrications requirements globally.

Mission

To produce 13,200 Tons of Steel Castings in the financial year 2008-09.

To serve the customers, with wide range of requirements starting from 0.5 kg to 12 Tons single casting from our different plants in different locations.

Emerge as one of the top 5 casting manufacturers in the world.

Awards and Recognition



FOUNDRY APPROVALS



BUREAU
VERITAS



Lloyd's Register



Germanischer Lloyd

OTHER CERTIFICATIONS



Norsok Approval for Duplex Steel Castings any weight range.



AD 2000-Merkblatt WO



Pressure Equipment Directive



IBR Approval for Well known Foundry IBR Castings upto 12000 kg/piece

Peekay Steel Castings in Renowned Projects

- JGC Hawiyah NGL
- RAS LAFAN Ethylene Cracker
- Jubail Chevron Philips
- RAS GAS II
- SNAM Kurusaniya
- Rabigh
- Woodside LNG
- Pearl GTL
- Shell GTL
- Tanguh LNG
- ONGC
- RIL

End Users

- Shell
- EnCana
- Sakhlain Energy
- Reliance
- ONGC
- Maersk
- Saudi Aramco

Approvals of Engineering Consultants for various Projects

- Chiyoda Corporation
- Japanese Gas Corporation
- Engineers India Ltd.
- Kawasaki Ship Building Corporation
- Mitsubishi Heavy Industries

Major Customers (Abroad)

M/s. Dresser Produits Industriels, France
M/s. GE Transportation, USA
M/s. Mokveld Valves, Netherlands
M/s. CCI, USA, South Korea, Austria
M/s. Severn Glocon Ltd., UK, Italy
M/s. SPX Process Equipments, USA, UK
M/s. Flowserve Sulphur Springs, USA
M/s. ARI – Armaturen Albert Richter GmbH & Co. KG, Germany
M/s. Leser GMBH & CO.KG , Germany
M/s. Flowserve Pte Ltd., Singapore
M/s. Truflo Rona, Belgium
M/s. Cooper Cameron Valves, USA
M/s. AST SPA, Italy
M/s. Sasakura Engineering Ltd., Japan
M/s. Tyco Valves, Netherlands
M/s. Champions Motors, USA
M/s. Helac Corporation, USA
M/s. Leslie Controls, USA
M/s. Leibherr Mining Equipment Co., USA
M/s. Braunschweiger Flammenfilter GmbH, Germany
M/s. Schuf Valve Technology GmbH, Germany
M/s. Woodward Governor, USA

(India)

M/s. Audco India Ltd, Manappakkam, Coimbatore,
Maraimalai Nagar, Kancheepuram
M/s. Fisher Sanmar Ltd., Chennai
M/s. Dresser Valve India Pvt. Ltd., Coimbatore
M/s. Tyco Valves & Controls India Pvt. Ltd., Chennai
M/s. Alstom Projects India Ltd., Vadodara
M/s. Flowserve India Controls Pvt. Ltd., Bangalore
M/s. Severn Glocon India Pvt Ltd., Chennai
M/s. Bharat Heavy Electricals Ltd, Tiruchirappalli
M/s. Advance Valve Pvt. Ltd., Noida
M/s. Faively Transport India Ltd., Hosur
M/s. Triveni Engineering & Industries Ltd, Bangalore
M/s. Econo Valves Pvt. Ltd., Chennai
M/s. Orbinox Valves, Coimbatore
M/s. Keromiyons, Coimbatore
M/s. Kent Introl Pvt. Ltd., Nashik
M/s. Instrumentation Ltd., Palakkad
M/s. Koso Fluid & Controls Pvt. Ltd., Palakkad
M/s. MIL Controls Ltd., Trissur
M/s. Niton Valves India Pvt. Ltd., Aurangabad
M/s. Worldwide Oilfield Equipments, Pune
M/s. Pitti Lamination Ltd., Hyderabad

Tooling



SOFTWARE AVAILABLE:

- SIMULATION SOFTWARE, FLUID FLOW, SOLIDIFICATION
- PRO-CAST
- SOLID WORKS
- CAVALIER
- CRUSADER



Patterns stored - 3,000 nos.
75,000 Sq. ft
Pattern storage area

Moulding

◀ Calicut



30 Ton IMF continuous mixer Alphasert process Heavy box moulding



Shell moulding
Matchplate Size: 600 x 450 x 250 mm



Coimbatore ▶

- 30 Ton IMF continuous mixer - Alphasert process
- Cake size 1600 x 1300 x 500 mm
- 10 Ton Omega mixer - Alphasert process - Loop line - cake size 1200 x 900 x 400 mm



Melting



Calicut

Medium Frequency Induction Furnaces:

- 150 kg
- 250 kg
- 3 Ton
- 5 Ton
- 6 Ton
- 10 Ton

Coimbatore

Medium Frequency Induction Furnaces:

- 500 kg
- 1.5 Ton
- 2 Ton

Fettling

Calicut

Ceramic lined H/T Furnace

- 10 Ton (Oil fired)
- 10 Ton (Oil fired)
- 6 Ton (Oil fired)
- 1 Ton (Electric)

Coimbatore

Ceramic lined H/T Furnace

- 10 Ton (Oil fired)
- 5 Ton (Oil fired)
- 3 Ton (Electric)



Quality Control



Spectro Meter

- Model : Spectro Lab - 22 elements
- Model : MLV [Including Nitrogen] - 11 elements

Wet analysis



- UTM - Computerized with Electronic Extensometer
 - 100 Ton
 - 40 Ton
- Impact Testing Machine - Upto -196°C
- Brinell Hardness Tester



Micro Structure - Inverted stage metallurgical Microscope with digital CCD camera.

Quality Control



- Dimensional inspection using FARO ARM



- In-house Radiography - Source Co.60, Ir.192



Machine Shop



- Horizontal Boring Machine (1 No.) - Spindle dia 130 mm x 900 mm stroke, X-Y-Z>2000 mm, Rotary Table 1800 mm x 2000 mm, Load Capacity 12 Tons with Facing, Milling and Slotting Attachments
- Vertical Turning Lathe (4 Nos.)
 - VTL1 - Double Coloumn Twin Ram Machine. Table dia 2500mm, Swing 2700 mm, Height 1900 mm
 - VTL2 - Double Coloumn Twin Ram Machine. Table dia 2250mm, Swing 2500 mm, Height 1600 mm
 - VTL3 - Table dia 1400 mm, Swing 1600 mm, Height 1200 mm
 - VTL4 - Table dia 1400 mm, Swing 1600 mm, Height 1000 mm
- Radial Drilling Machine (2 Nos.)
 - RD1 - Arm length 3000 mm, Height 2500 mm, Drill Capacity 100 mm
 - RD2 - Arm length 2000 mm, Height 1800 mm, Drill Capacity 80 mm
- Hydro Testing Machine (2 Nos.)
 - HYD1 - Max dia of casting 1200 mm, Length 1000 mm, Pressure 100 Bar, Clamping Tonnage 500 Ton, Semi Automatic CNC control with Electronic Pressure Guage, Max weight of casting 2.5 Ton
 - HYD2 - Max dia of casting 1600 mm, Length 2500 mm, Pressure 250 Bar, Clamping Tonnage 1200 Ton, Fully Automatic CNC control with Electronic Pressure Guage, Max weight of casting 8000 Ton



Products

8"x 16" Cl. 900 BWE Body,
Weight 1210 kg,
Customer: M/s.CCI



24" Cl. 600 Body,
Weight 5960 kg,
Customer: M/s. Dresser Produits industriels



20" Cl. 1500 Body,
Weight 5055 kg,
Customer: M/s. Audco India Ltd



40" Cl. 600 WE Body,
Weight 3540 kg,
Customer: M/s. Mokveld Valves BV

12" Cl. 1500 Body,
Weight 3390 kg,
Customer: M/s. Fisher Sanmar Ltd

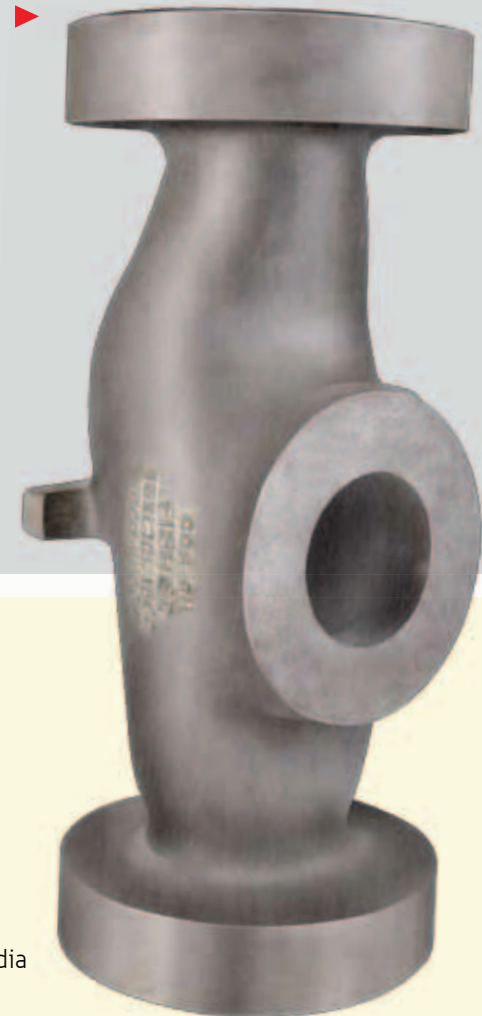

18" Cl. 300/600 Body,
Weight 1940 kg,
Customer: M/s. Flowserve India
Controls Pvt. Ltd

Products



16" BW TMBV Body,
Weight 500 kg,
Customer: M/s. Flowserve Sulphur Springs

20" Support Flange,
Weight 65 kg,
Customer: M/s. Sasakura



10" 300 Body,
Weight 354 kg,
Customer: M/s. Severn Glocon India Ltd



20" Body,
Weight 316.20 kg,
Customer: M/s. Sasakura



8" CI 900 Body,
Weight 383.60 kg,
Customer: M/s. Mokveld Valves BV



300 mm Fig 14 Body,
Weight 35 kg,
Customer: M/s. Tyco Valves

24" Fig 362 Lugged Bodies,
Weight 258 kg,
Customer: M/s. Tyco Valves Controls



24" Fig 362 Lugged Bodies,
Weight 258 kg,
Customer: M/s. Tyco Valves Controls



Cylinder Head,
Weight 36 kg,
Customer: M/s. GE Transportation



HS Carrier,
Weight 376.60 kg,
Customer: M/s. GE Transportation



Stator Support,
Weight 102.74 kg,
Customer: M/s. GE Transportation



Mount Tank,
Weight 54 kg,
Customer: M/s. Leibherr Mining
Equipment Company



Coupler Body,
Weight 210 kg,
Customer: M/s. Faively



U Tube,
Weight 250 kg
Customer: M/s. GE Transportation



Shell Castings, Customer: M/s. Ari - Armaturen Albert Richter GmbH & Co. KG
M/s. Leser GmbH & Co. KG



Training



PeeKay Steel family has 560 members. The success of the company is attributed to the strength and unity of the members of this family. We are conscious of our skills, passion, quality, strength and strong values. We have a value based approach; our indomitable spirit, commitment and hard work have won the appreciation of our customers.

Loyalty and values are the basic fabric of our work philosophy. Every employee is a partner in our progress and benefits from our profits. He is proud of his contribution to the success of the company. We have regular in-plant training programme for upgrading the skills of the employees and familiarizing them with the latest in technology and manufacturing processes. Very often the employees are also deputed for short term courses conducted by specialized agencies. The company is committed to the health and safety of all members. A separate wing of safety experts are working round the clock to ensure safety measures in the company and also to educate the employees for better work environment.

People and Safety



Environment

We are conscious of our responsibility for the environmental safety. We abide by the various statutory rules and regulations for the environmental protection and pollution control. We have started taking steps for a totally dust free atmosphere in the foundry which will ensure health and safety of the employees and smooth and safe functioning of the foundry. Our aim is to obtain ISO 14001 Certification relating to environment management system by 2009-2010. This will help to improve the productivity level of our employees which will ultimately ensure better quality and delivery of our products at lower costs.

Applications

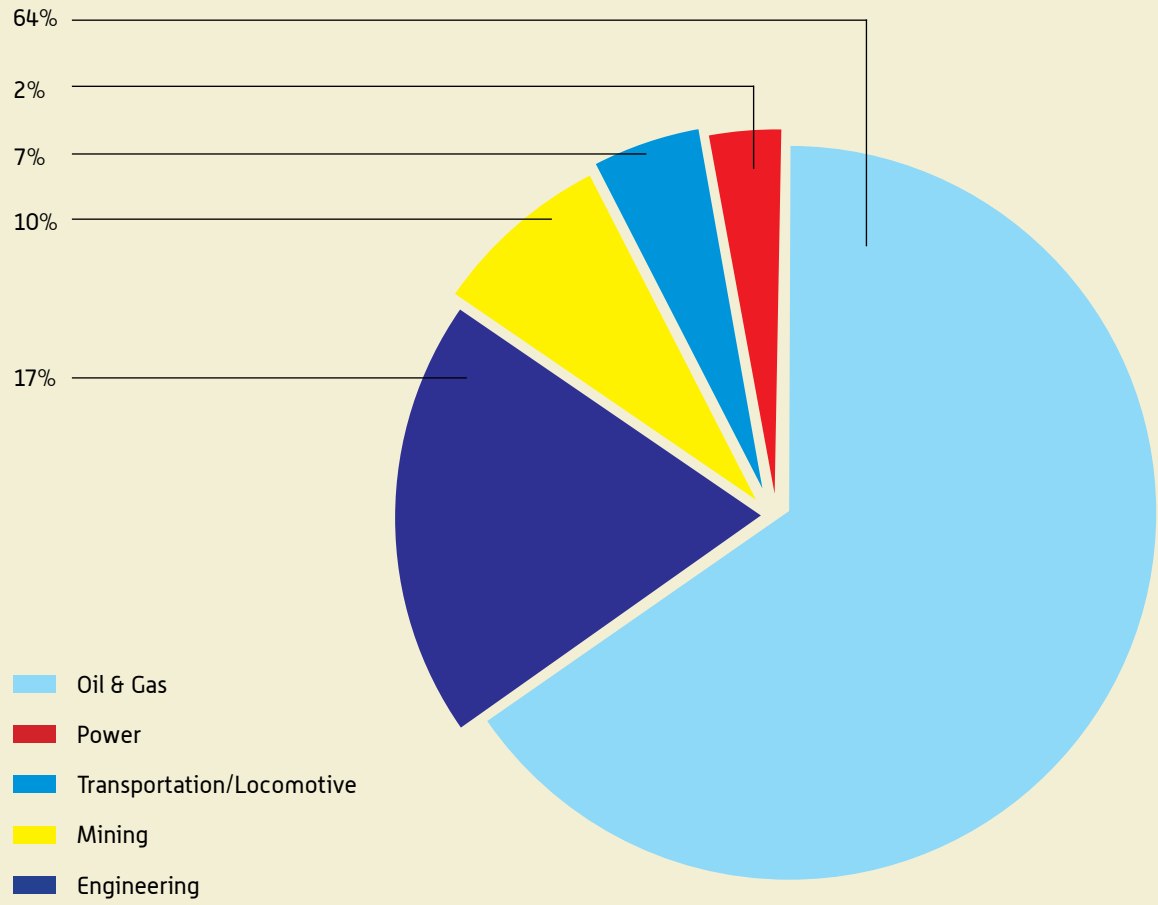

Location

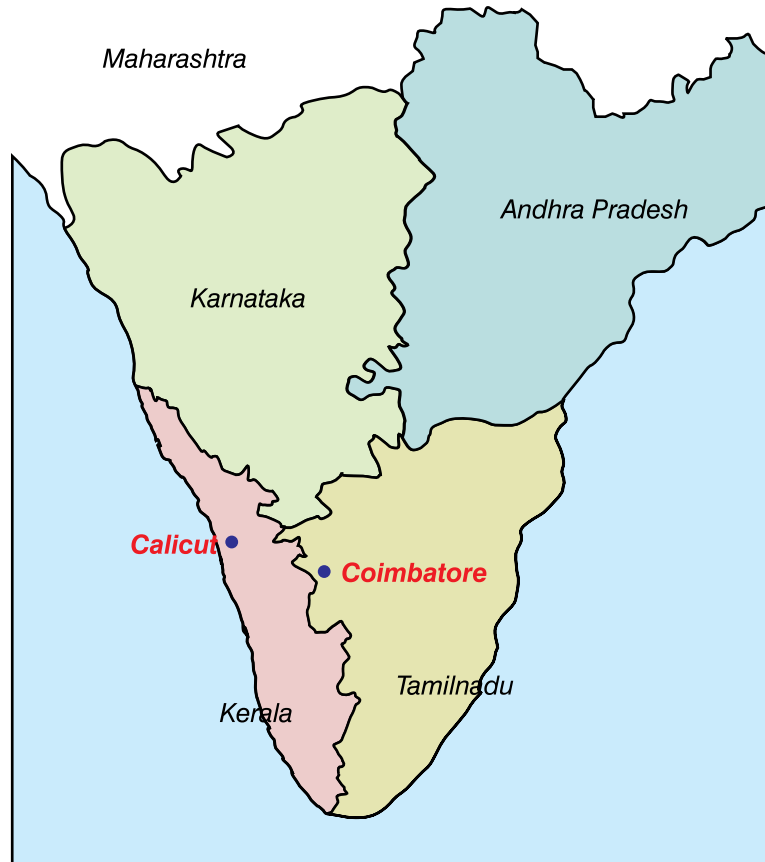

Calicut

- Nearest Airports:** Calicut International Airport 26 Kms
Cochin International Airport 185 Kms
- Nearest Seaports:** Cochin, about 210 Kms
Mangalore, about 240 Kms
- By Road:** 6 Kms from Calicut town towards south by NH 17
210 Kms from Kochi (Cochin) towards north
- By Rail:** Calicut Railway Station, 5 Kms from factory

Coimbatore

- Nearest Airports:** Coimbatore Airport 35 Kms
- Nearest Seaports:** Tuticorin, about 350 Kms
Cochin, about 350 Kms
- By Road:** 25 Kms from Coimbatore towards Mettupalayam by NH 17
- By Rail:** Coimbatore Railway Station, 25 Kms from factory



PEEKAY STEEL CASTINGS PVT. LTD.

Nallalam, Calicut 673 027, Kerala, India.

Tel: +91 495 2421701,703,704,707

Mob: +91 98474 03234, Fax: +91 495 2420724

Email: pkgroup@eth.net , info@peekaysteel.com, sales@peekaysteel.com

www.peekaysteel.com

PEEKAY STEEL CASTINGS PVT. LTD.

4/242, Chinnamaddampalayam, Bilichi Post, Coimbatore-641 019, Tamilnadu, India

Tel: +91 4254 274433, 275301, Fax: +91 4254 274533

Email: info@pkcbe.co.in, sales@pkcbe.co.in

www.pkcbe.co.in